



Freehold Street, Shoreham-By-Sea

- First Floor Apartment
- South Facing Balcony
- Two Bedroom Apartment
- Excellent Location
- Available Now
- EPC Rating - C

£1,195

Robert Luff & Co are delighted to offer this two bedroom, first floor apartment, situated in the center of Shoreham moments away from the amenities. The accommodation comprises of modern bathroom, good sized kitchen, living room, two double bedrooms and a south facing balcony.

AVAILABLE NOW

T: 01903 331247 E: info@robertluff.co.uk
www.robertluff.co.uk

**Robert
Luff & Co**
 Sales | Lettings | Commercial



Accommodation



30 Guildbourne Centre, Worthing, West Sussex, BN11 1LZ
T: 01903 331247 E: info@robertluff.co.uk
www.robertluff.co.uk

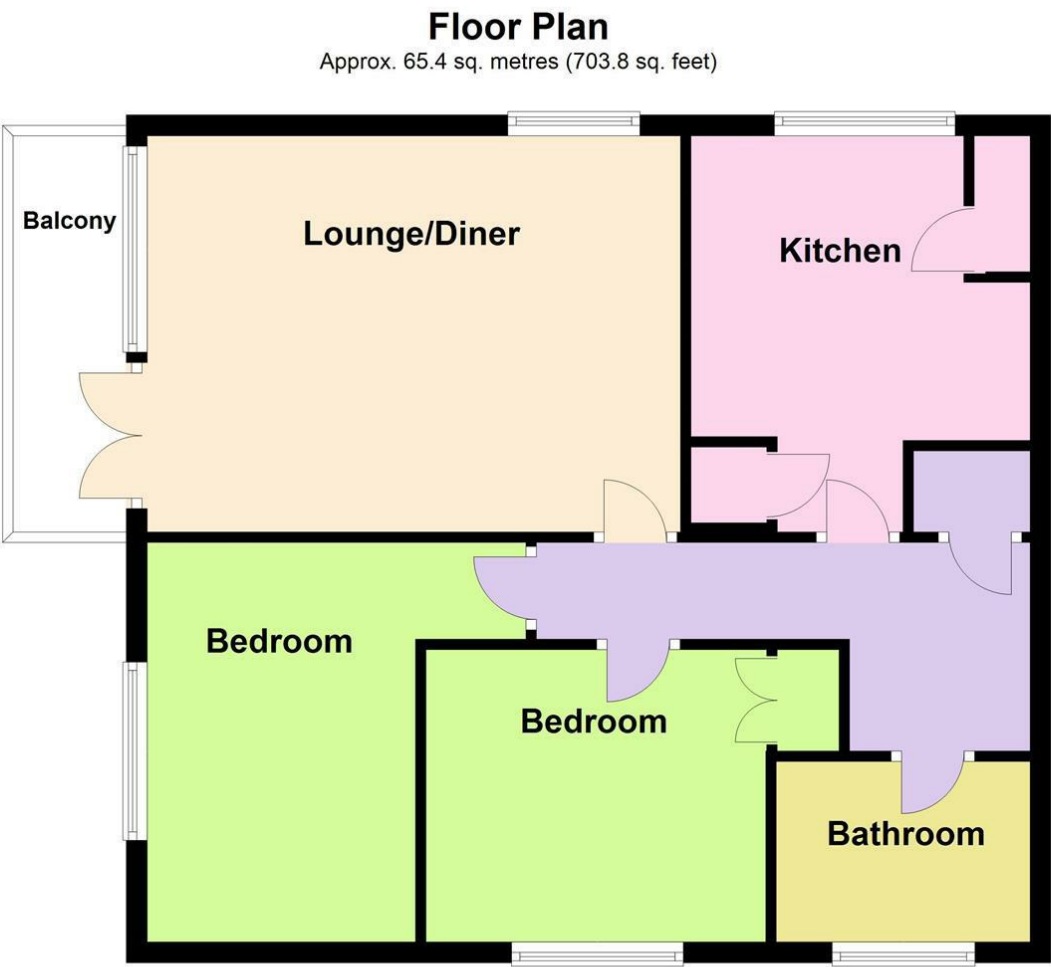

Total area: approx. 65.4 sq. metres (703.8 sq. feet)

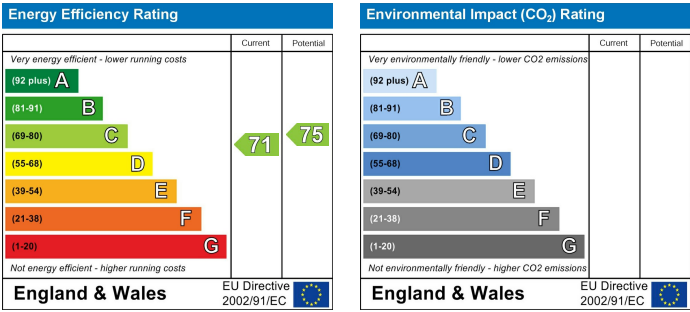

The information provided about this property does not constitute or form any part of an offer or contract, nor may it be regarded as representations. All interested parties must verify accuracy and your solicitor must verify tenure/lease information, fixtures and fittings and, where the property has been extended/converted, planning/building regulation consents. All dimensions are approximate and quoted for guidance only as are floor plans which are not to scale and their accuracy cannot be confirmed. References to appliances and/or services does not imply that they are necessarily in working order or fit for the purpose.